



*Live the
Elite Way...*



INTRODUCTION



A signature project by Raviraj Group which claims to provide you the comfort of your very own Palace. Raviraj Royal is an iconic residential project that offers you cr me de la cr me lifestyle. The interception of classic architecture and modernism would be the most perfect way to describe Raviraj Royal. Royal provides for lifestyle needs – real and imagined. We believe happiness shouldn't have limitations and hence we have grand living areas just for you. Situated in the heart of the financial hub of India, Western Suburbs in Mumbai. Designed to provide easy connectivity and reach with international schools, malls, healthcare facilities and multiplexes in the vicinity along with an easy access to the National Highway, bus depots, railway station.

So Come and Explore the true sense of being the King/Queen of a Castle you always dreamed about at Raviraj Royal!!

Parent Company: RaviRaj Group of Companies

Builder: M/s Raviraj Developers

Architect: Sanjay B. Shah

Design Consultant: C.V Antony

Legal Advisor: S.D. Mishra

RCC consultant: Hiren Tanna





A Wing -FLAT No. 1 to 4
1 BHK PLAN



B Wing -FLAT No. 1 & 2
1 BHK PLAN



B Wing -FLAT No. 3 & 4
2 BHK PLAN





SHANTILAL MODI CROSS ROAD NO.-2.

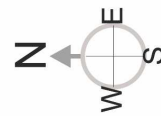
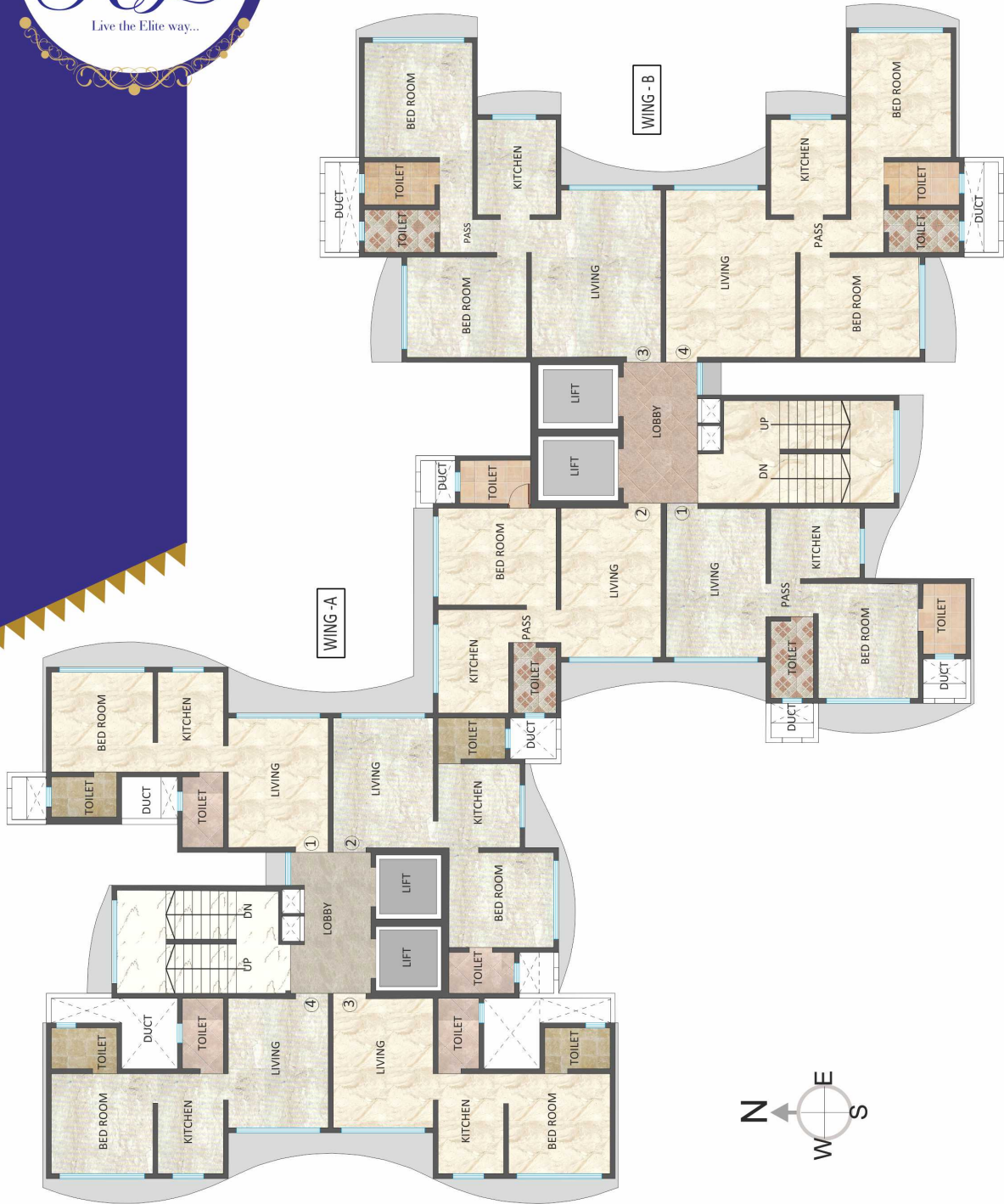

HEMUKALANI ROAD

AMENITIES:



- Ample Car Parking Space with double podium
- CCTV Camera Surveillance
- Intercom Facility in each Flat
- High Speed Elevators
- Stylish Lobby & Elegant Elevation
- Piped Gas Connection
- 100% Power Backup for essentials in common areas



SPECIFICATIONS:



- Weather proof cement and appex paint (exterior) Oil bond paint (interior)
- Vitrified tiles flooring
- Concealed wiring with electrical layout and adequate points
- Sliding windows of color anodized section with tinted glass
- Laminated finish doors & main door with quality brass fittings & locks
- Plaster of Paris on walls with premium quality paint in all rooms
- Granite kitchen platform with separate cooking & service platform
- Stainless steel sink and provision of exhaust fan
- Full tiles dado kitchen
- Designer tiles in bathroom & W.C.
- Granite frame in bathroom, W.C. & all windows
- Decorative laminate finish doors
- Geyser & Wash basins in all bathrooms
- Concealed Plumbing with branded C.P. fittings
- TV and Telephone points in living room & bedrooms



BEST FEATURES:



- VastuShastra friendly
- Loan from all Financial Institute
- Good education and healthcare facilities nearby
- Clear Marketable title
- Timely possession
- High strength earthquake protected RCC structure



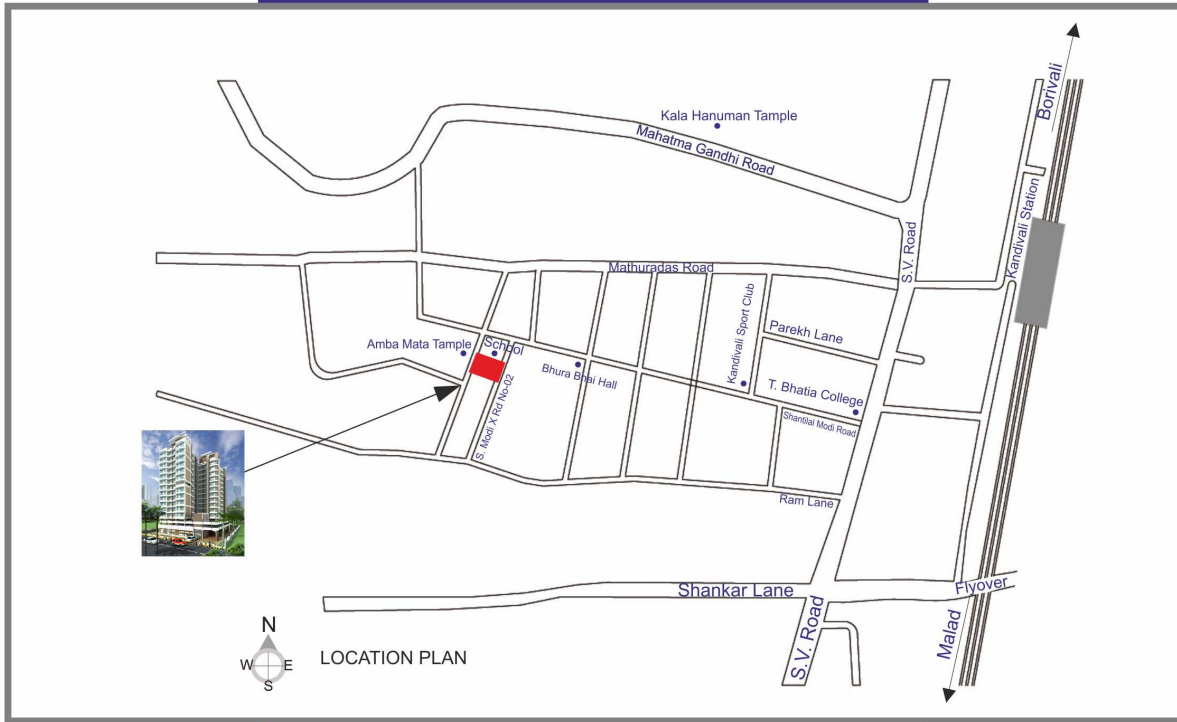

SITE ADDRESS

CTS No. 256, Shantilal Modi Road No. 2,
Opp. Amba Mata Temple, Iraniwadi,
Kandivali (West), Mumbai-400067.



A Project By:

RAVIRAJ DEVELOPERS

A/101, Radharaman Apartment, Babu Bhagve Road,
Kandarpada, Dahisar (W), Mumbai- 400 068.

Tel.: 022 28914113/4

Email: ravirajhousing11@gmail.com

Web: www.ravirajhousing.com

Marketing By :

SURA ESTATE CONSULTANCY

9930308293 / 9820074419